

GOURDIE-FRASER
123 West Front Street
Traverse City, Michigan 49684

Date: March 23, 2017

ADDENDUM #1

| <u>PROJECT</u> | <u>BIDS DUE</u> |
|---|---|
| 2017 Water Main Replacement for the Village of Central Lake | Date: March 29, 2017 Time: 11:00 am Location: Village of Central Lake |

GFA Project No: 16374

The Addendum is issued prior to the receipt of bid proposals to amend the Contract Documents as follows. Bidders shall acknowledge receipt of this addendum by means of a handwritten note on the Bid Schedule.

Front End

1. The Bid Form shall be stricken in its entirety and be replaced with the following attached EJCDC C-410 Bid Form. Bidders shall use the Bid Form included in this addendum when submitting a Bid. The following identifies the change:
 - a. Modification of 2 inch live tap to reflect a 2 inch service lead installation

Bid Drawings and Specifications

1. Specification 13, Section 12.02.B and Paving Detail on drawing sheet 3.2 Clarification: The road paving shall be two (2) lifts of 165 pound / square yards (each) for a total of 3 inches compacted. Asphalt to be placed shall be 4E1 (Tier 1) compliant with MDOT standards. The asphalt prime of 0.25 gal / syd shall be applied between the asphalt lifts, not on the gravel base.
2. Specification 13, Section 12.02.B and Driveway Detail on drawing sheet 3.2 Clarification: The driveway paving shall be one (1) lift of 220 pound / square yards. Asphalt to be placed shall be 4E1 (Tier 1) compliant with MDOT standards. No asphalt prime application is necessary.
3. Sheet C2.3 has been updated to eliminate the proposed new 6" main to the existing 2" main in two locations at Covert Street via 2" tapping sleeve & valve. Contractor shall install utilizing a 2 inch tap and saddle with a 2 inch curb stop and box comparable to a the installation of a service lead as a conventional tapping sleeve and valve is not available for that size. The system must remain online and operational, service disruption must be prevented. Refer to the standard lead connection detail on Sheet 3.1 and Specification 9.02.G for additional information. Sheet C2.3 shall be stricken in its' entirety from the bid package and replaced with the revised sheet including with this addendum.

This Addendum No. 1 becomes part of the Contract Documents as of this date and supersedes the information in the originally issued Contract Documents where applicable. The Contractor shall acknowledge receipt of the Addendum in the Bid Schedule included with his/her bid.

ARTICLE 1 – BID RECIPIENT

- 1.01 This Bid is submitted to: Village of Central Lake, 1622 M-88, Central Lake, MI 49622
- 1.02 The undersigned Bidder proposes and agrees, if this Bid is accepted, to enter into an Agreement with Owner in the form included in the Bidding Documents to perform all Work as specified or indicated in the Bidding Documents for the prices and within the times indicated in this Bid and in accordance with the other terms and conditions of the Bidding Documents.

ARTICLE 2 – BIDDER’S ACKNOWLEDGEMENTS

- 2.01 Bidder accepts all of the terms and conditions of the Instructions to Bidders, including without limitation those dealing with the disposition of Bid security. This Bid will remain subject to acceptance for 90 days after the Bid opening, or for such longer period of time that Bidder may agree to in writing upon request of Owner.

ARTICLE 3 – BIDDER’S REPRESENTATIONS

- 3.01 In submitting this Bid, Bidder represents that:
 - A. Bidder has examined and carefully studied the Bidding Documents, and any data and reference items identified in the Bidding Documents, and hereby acknowledges receipt of the following Addenda:

| <u>Addendum No.</u> | <u>Addendum, Date</u> |
|---------------------|-----------------------|
| _____ | _____ |
| _____ | _____ |
| _____ | _____ |
| _____ | _____ |

- B. Bidder has visited the Site, conducted a thorough, alert visual examination of the Site and adjacent areas, and become familiar with and satisfied itself as to the general, local, and Site conditions that may affect cost, progress, and performance of the Work.
- C. Bidder is familiar with and has satisfied itself as to all Laws and Regulations that may affect cost, progress, and performance of the Work.
- D. Bidder has considered the information known to Bidder itself; information commonly known to contractors doing business in the locality of the Site; information and observations obtained from visits to the Site; the Bidding Documents; and any Site-related reports and drawings identified in the Bidding Documents, with respect to the effect of such information, observations, and documents on (1) the cost, progress, and performance of the Work; (2) the means, methods, techniques, sequences, and procedures of construction to be employed by Bidder; and (3) Bidder’s safety precautions and programs.
- E. Bidder agrees, based on the information and observations referred to in the preceding paragraph, that no further examinations, investigations, explorations, tests, studies, or data are necessary for the determination of this Bid for performance of the Work at the price bid and within the times required, and in accordance with the other terms and conditions of the Bidding Documents.

- F. Bidder is aware of the general nature of work to be performed by Owner and others at the Site that relates to the Work as indicated in the Bidding Documents.
- G. Bidder has given Engineer written notice of all conflicts, errors, ambiguities, or discrepancies that Bidder has discovered in the Bidding Documents, and confirms that the written resolution thereof by Engineer is acceptable to Bidder.
- H. The Bidding Documents are generally sufficient to indicate and convey understanding of all terms and conditions for the performance and furnishing of the Work.
- I. The submission of this Bid constitutes an incontrovertible representation by Bidder that Bidder has complied with every requirement of this Article, and that without exception the Bid and all prices in the Bid are premised upon performing and furnishing the Work required by the Bidding Documents.

ARTICLE 4 – BIDDER’S CERTIFICATION

4.01 Bidder certifies that:

- A. This Bid is genuine and not made in the interest of or on behalf of any undisclosed individual or entity and is not submitted in conformity with any collusive agreement or rules of any group, association, organization, or corporation;
- B. Bidder has not directly or indirectly induced or solicited any other Bidder to submit a false or sham Bid;
- C. Bidder has not solicited or induced any individual or entity to refrain from bidding; and
- D. Bidder has not engaged in corrupt, fraudulent, collusive, or coercive practices in competing for the Contract. For the purposes of this Paragraph 4.01.D:
 - 1. “corrupt practice” means the offering, giving, receiving, or soliciting of any thing of value likely to influence the action of a public official in the bidding process;
 - 2. “fraudulent practice” means an intentional misrepresentation of facts made (a) to influence the bidding process to the detriment of Owner, (b) to establish bid prices at artificial non-competitive levels, or (c) to deprive Owner of the benefits of free and open competition;
 - 3. “collusive practice” means a scheme or arrangement between two or more Bidders, with or without the knowledge of Owner, a purpose of which is to establish bid prices at artificial, non-competitive levels; and
 - 4. “coercive practice” means harming or threatening to harm, directly or indirectly, persons or their property to influence their participation in the bidding process or affect the execution of the Contract.

ARTICLE 5 – BASIS OF BID

5.01 Bidder will complete the Work in accordance with the Contract Documents for the following price(s):

BID FORM

| Item No. | Description | Unit | Estimated Quantity | Bid Unit Price | Bid Price |
|-----------------|---|-------------|---------------------------|-----------------------|------------------|
| 1 | Water Main, PVC C900, 6" | LF | 3,900 | | |
| 2 | Water Main, PVC C900, Dir. Drilled, 6" | LF | 130 | | |
| 3 | Gate Valves & Boxes, 6" | EA | 2 | | |
| 4 | Tapping Sleeves & Valves, All Sizes Live Tap | EA | 7 | | |
| 5 | Fire Hydrant Assembly | EA | 6 | | |
| 6 | Connect to Existing Water Main | EA | 1 | | |
| 7 | Cut & Plug, (Abandon) Existing Water Main | EA | 10 | | |
| 8 | Water Service Leads Transfer (Connect to Existing Lead), 1" | EA | 29 | | |
| 9 | Meter Pit Water Service Leads Transfer (Connect to Existing Lead), 1" | EA | 29 | | |
| 10 | Service Lead, 1" | LF | 1,200 | | |
| 11 | Service Lead, 2" | LF | 25 | | |
| 12 | Curb Stop and Box, 1" | EA | 3 | | |
| 13 | Curb Stop and Box, 2" | EA | 1 | | |
| 14 | Corporation Stop, 1" | EA | 61 | | |
| 15 | Corporation Stop, 2" | EA | 1 | | |
| 16 | Concrete Sidewalk, Patch | SF | 520 | | |
| 17 | Asphalt Drive, Patch | SY | 65 | | |
| 18 | Asphalt Road, Patch | SY | 260 | | |
| 19 | Asphalt, Road Removal/Replacement | TN | 980 | | |
| 20 | Concrete Drive, Patch | SF | 115 | | |
| 21 | Restoration | LS | 1 | | |

| Item No. | Description | Unit | Estimated Quantity | Bid Unit Price | Bid Price |
|--|-------------|------|--------------------|----------------|-----------|
| Total of All Unit Price Bid Items | | | | | \$ |

Bidder acknowledges that (1) each Bid Unit Price includes an amount considered by Bidder to be adequate to cover Contractor's overhead and profit for each separately identified item, and (2) estimated quantities are not guaranteed, and are solely for the purpose of comparison of Bids, and final payment for all unit price Bid items will be based on actual quantities, determined as provided in the Contract Documents.

Total of Unit Price Bids = Total Bid Price \$ _____

ARTICLE 6 – TIME OF COMPLETION

- 6.01 Bidder agrees that the Work will be substantially complete and will be completed and ready for final payment in accordance with Paragraph 15.06 of the General Conditions on or before the dates or within the number of calendar days indicated in the Agreement.
- 6.02 Bidder accepts the provisions of the Agreement as to liquidated damages.

ARTICLE 7 – ATTACHMENTS TO THIS BID

- 7.01 The following documents are submitted with and made a condition of this Bid:
 - A. Required Bid Bond or Security;
 - B. Bidder's Experience Form/List of Subcontractors

ARTICLE 8 – DEFINED TERMS

- 8.01 The terms used in this Bid with initial capital letters have the meanings stated in the Instructions to Bidders, the General Conditions, and the Supplementary Conditions.

ARTICLE 9 – BID SUBMITTAL

BIDDER: *[Indicate correct name of bidding entity]*

By: _____
[Signature]

[Printed name]
 (If Bidder is a corporation, a limited liability company, a partnership, or a joint venture, attach evidence of authority to sign.)

Attest:
[Signature] _____

[Printed name] _____

Title: _____

Submittal Date: _____

Address for giving notices:

Telephone Number: _____

Fax Number: _____

Contact Name and e-mail address: _____

Bidder's License No.: _____
(where applicable)

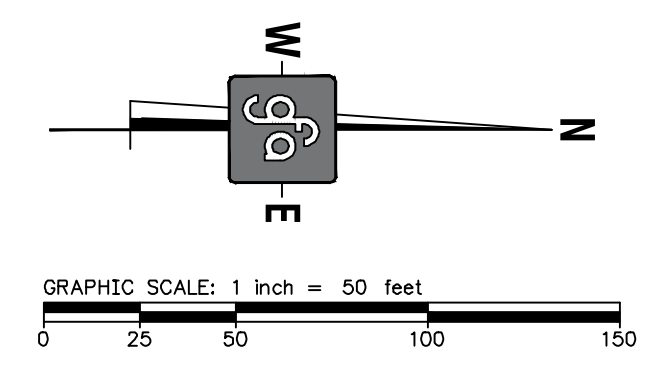
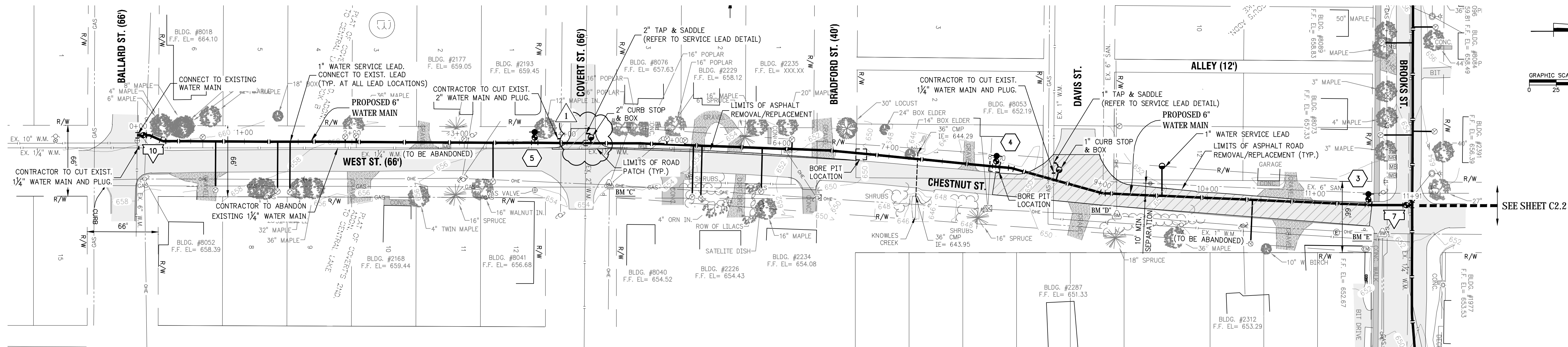

BENCHMARKS

BENCHMARK "C"
 BENCH-TIE WEST FACE UTILITY POLE
 ELEV.= 655.26 (NAVD88)

BENCHMARK "D"
 BENCH-TIE WEST FACE UTILITY POLE
 ELEV.= 652.55 (NAVD88)

BENCHMARK "E"
 BENCH-TIE EAST FACE UTILITY POLE
 ELEV.= 652.98 (NAVD88)

NOTES

- CONTRACTOR TO UTILIZE TRENCH BOX AS NECESSARY TO MINIMIZE DISRUPTION/DAMAGE TO LANDSCAPING AND BITUMINOUS. ANY DAMAGE OUTSIDE LIMITS AS DEFINED ON THIS SHEET TO BE REPAIRED/REPLACED AT NO ADDITIONAL COST TO THE PROJECT. BITUMINOUS TO BE PAID AS DEFINED IN MEASUREMENT/PAYMENT SPECIFICATION.
- CONTRACTOR TO INSTALL ALL LEADS BY TRENCHLESS METHOD AS APPROVED BY ENGINEER. (FOR CHESTNUT ST./WEST ST. ONLY)
- CONTRACTOR TO UTILIZE SOIL EROSION CONTROL MEASURES TO CONTAIN DRILL FLUIDS WITHIN PIT LIMITS AND PROTECT CREEK.

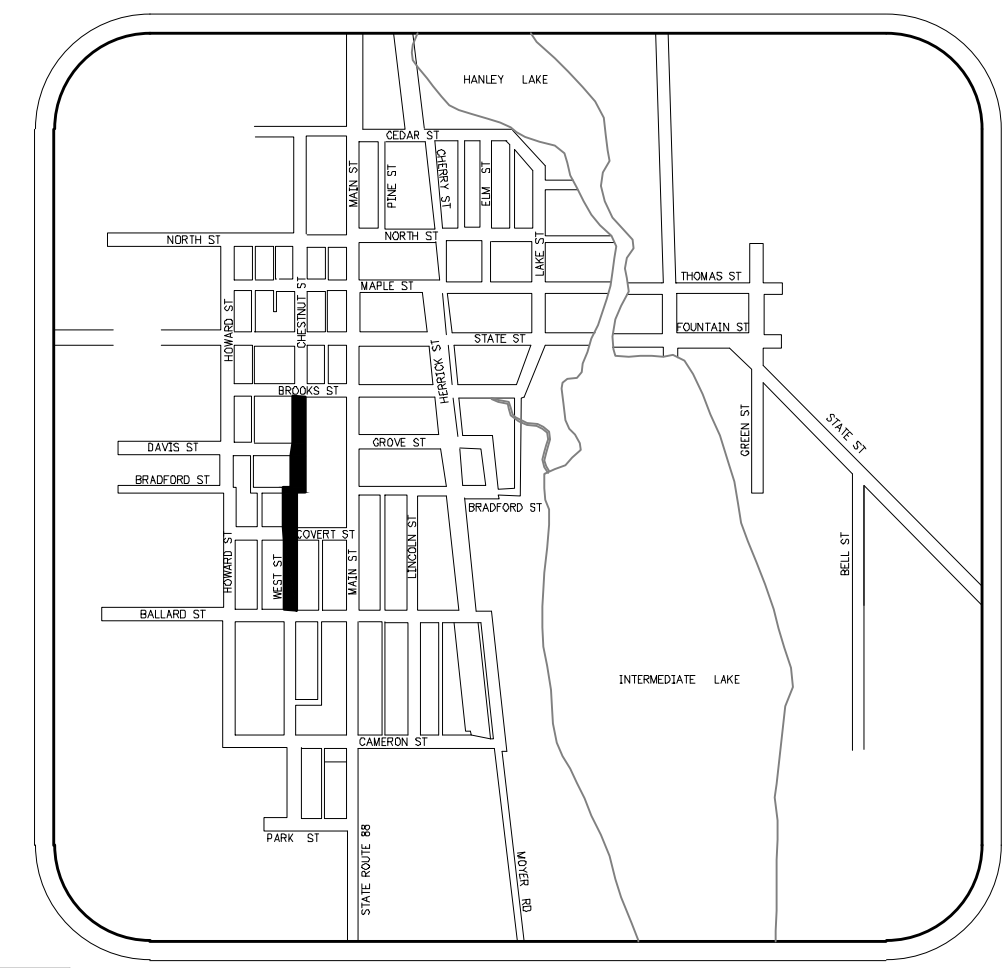

**WEST/CHESTNUT STREET WATER MAIN PROFILE
 (STA. 0+00 TO 11+91)**
 SCALE:
 HORIZONTAL: 1" = 50'
 VERTICAL: 1" = 5'

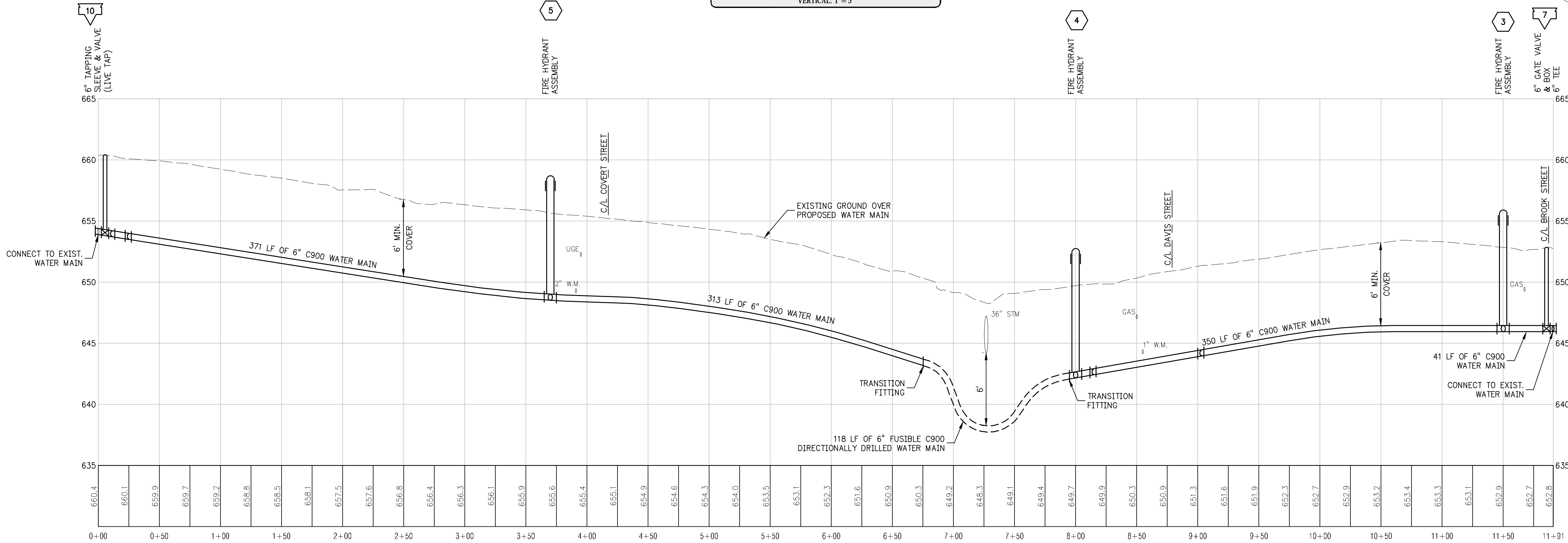

| REV# | DATE | BY | CHK | DESCRIPTION |
|------|------------|-----|------------------|-------------|
| 1 | 02/25/2017 | CPW | ESTD FOR PERMITS | |
| 2 | 02/25/2017 | CPW | ESTD FOR PERMITS | |
| 3 | 02/25/2017 | CPW | ESTD FOR PERMITS | |

**VILLAGE OF CENTRAL LAKE
 2107 WATER MAIN REPLACEMENT
 PLAN AND PROFILE SHEET
 SECTIONS 22, 23, & 27, T.31 N., R.8 W.
 VILLAGE OF CENTRAL LAKE, ANTRIM COUNTY, MICHIGAN**

These documents are prepared in accordance with the contractual terms and conditions for this project.